



STEEL REFILLABLE REFRIGERANT

EUROPE

42 bar cylinders

According to the ADR P200 Packing Instructions, R-410A requires 42 bar minimum test pressure. Worthington's new cylinder design at 42 bar aligns with these regulations and is more lightweight than ever before!

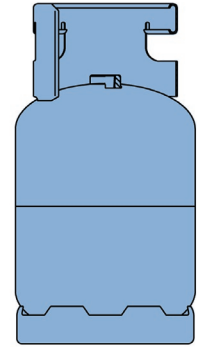
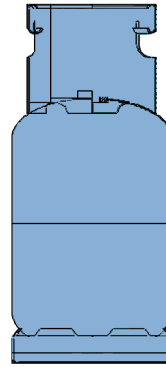
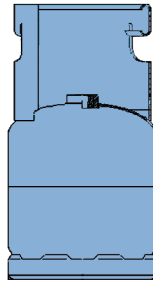

SPECIFICATIONS

DRAWING NUMBER	12W483	12W484	12W485
WATER CAPACITY	6 liters	12,5 liters	14,3 liters
TARE WEIGHT	5,0 kg	6,8 kg	8 kg
CYLINDER OUTSIDE DIAMETER	202 mm	229 mm	250 mm
COLLAR OUTSIDE DIAMETER	185 mm	185 mm	200 mm
FOOTRING OUTSIDE DIAMETER	200 mm	229 mm	246 mm
CYLINDER HEIGHT	374 mm	518 mm	475 mm
MANUFACTURING STANDARD	TPED EN13322-1	TPED EN13322-1	TPED EN13322-1
TEST PRESSURE	42 bar	42 bar	42 bar

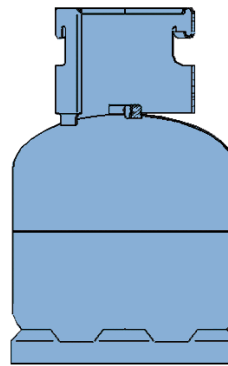
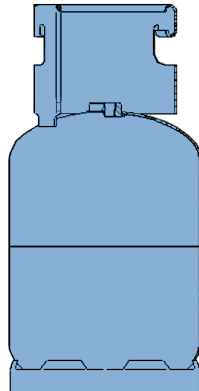

SPECIFICATIONS

DRAWING NUMBER	12W486	12W487
WATER CAPACITY	14,5 liters	19 liters
TARE WEIGHT	8 kg	10 kg
CYLINDER OUTSIDE DIAMETER	250 mm	300 mm
COLLAR OUTSIDE DIAMETER	185 mm	185 mm
FOOTRING OUTSIDE DIAMETER	246 mm	304 mm
CYLINDER HEIGHT	520 mm	497 mm
MANUFACTURING STANDARD	TPED EN13322-1	TPED EN13322-1
TEST PRESSURE	42 bar	42 bar



WORTHINGTON
CYLINDERS
A Worthington Industries Company

Worthington Cylinders Portugal
Rua Da Granja 530
3730-205 Vale de Cambra
Tel. 351 256 420 440
worthington@wthg.pt
WorthingtonCylinders.com



STEEL REFILLABLE REFRIGERANT

EUROPE

42 bar cylinders

According to the ADR P200 Packing Instructions, R-410A requires 42 bar minimum test pressure. Worthington's new cylinder design at 42 bar aligns with these regulations and is more lightweight than ever before!

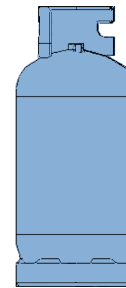

SPECIFICATIONS

DRAWING NUMBER	12W488	12W489	12W491
WATER CAPACITY	27,2 liters	40 liters	61 liters
TARE WEIGHT	12,5 kg	16 kg	23 kg
CYLINDER OUTSIDE DIAMETER	300 mm	318 mm	300 mm
COLLAR OUTSIDE DIAMETER	185 mm	185 mm	185 mm
FOOTRING OUTSIDE DIAMETER	300 mm	304 mm	300 mm
CYLINDER HEIGHT	630 mm	766 mm	1140 mm
MANUFACTURING STANDARD	TPED EN13322-1	TPED EN13322-1	TPED EN13322-1
TEST PRESSURE	42 bar	42 bar	42 bar

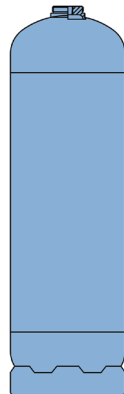

SPECIFICATIONS

DRAWING NUMBER	12W492	12W522
WATER CAPACITY	61 liters	61 liters
TARE WEIGHT	22,5 kg	23 kg
CYLINDER OUTSIDE DIAMETER	300 mm	267 mm
COLLAR OUTSIDE DIAMETER	N/A	200 mm
FOOTRING OUTSIDE DIAMETER	300 mm	267 mm
CYLINDER HEIGHT	1030 mm	1340 mm
MANUFACTURING STANDARD	TPED EN13322-1	TPED EN13322-1
TEST PRESSURE	42 bar	42 bar



WORTHINGTON
CYLINDERS
A Worthington Industries Company

Worthington Cylinders Portugal
Rua Da Granja 530
3730-205 Vale de Cambra
Tel. 351 256 420 440
worthington@wthg.pt
WorthingtonCylinders.com